

### KEY NOTES

- 11 Existing Single-Ply Membrane
- 14 Existing Structural Deck and Insulation Assembly
- 41 Approved Primer
- 53 AlphaGuard PUMA Base Coat
- 61 AlphaGuard Glass Mat or Permafab
- 73 AlphaGuard PUMA Top Coat

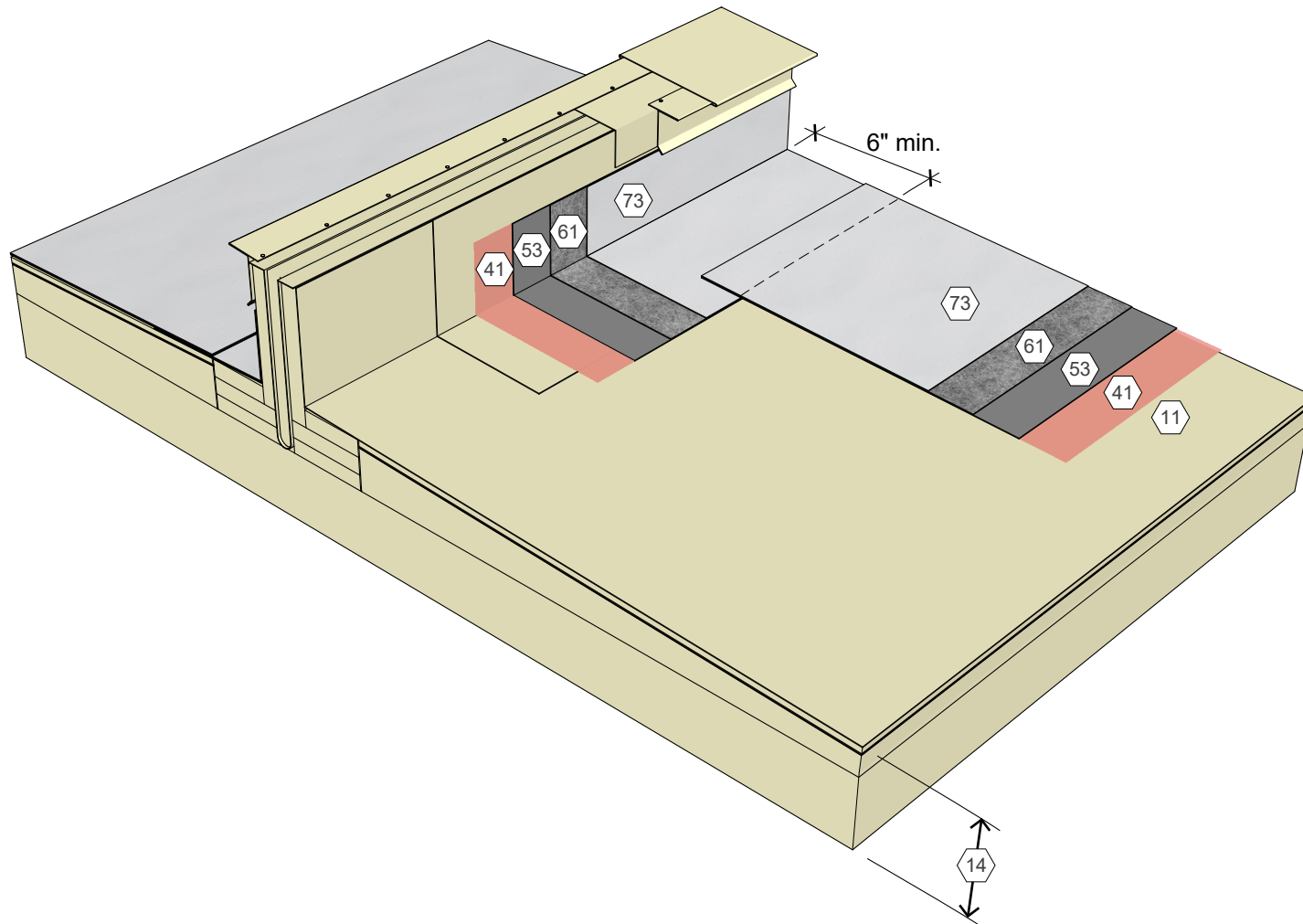

AlphaGuard® PUMA Restoration Detail, Single-Ply, Expansion Joint  
Detail 14081

**KEY NOTES**

- 12 Existing Existing MB or Smooth BUR
- 14 Existing Structural Deck and Insulation Assembly
- 41 Approved Primer
- 53 AlphaGuard PUMA Base Coat
- 61 AlphaGuard Glass Mat or Permafab
- 73 AlphaGuard PUMA Top Coat

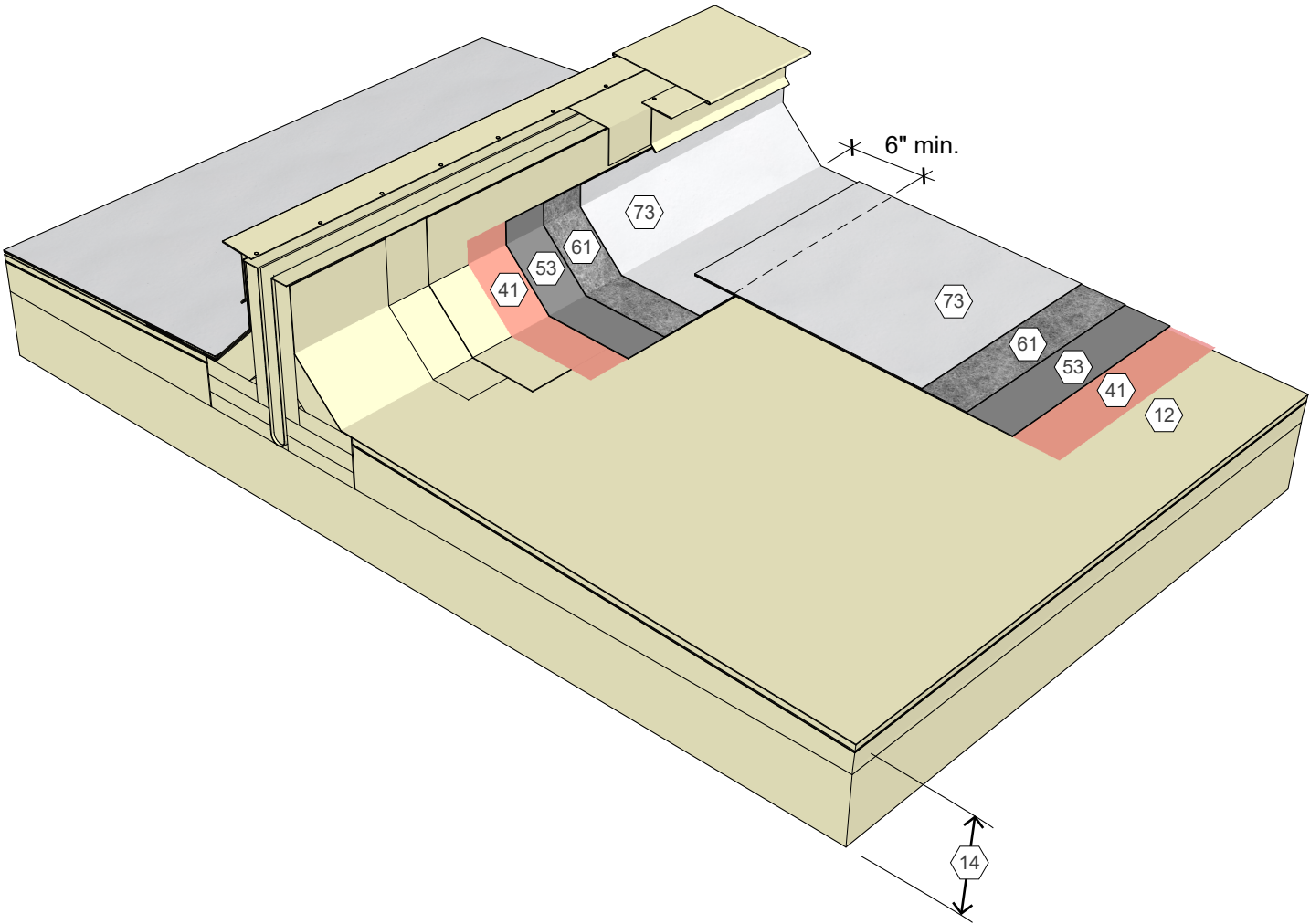

AlphaGuard® PUMA Restoration Detail, MB or Smooth BUR, Expansion Joint  
Detail 14082

